

NETTHINGS®



NETTHINGS UNIVERSAL DISPLAY

INSTALLATION GUIDE



NetThings Ltd
14 New Mart Road
Edinburgh
EH14 1RL
UK

E: info@netthings.co.uk
T: +44 (0) 131 331 5445

INSTALLATION OVERVIEW

The NetThings Universal Display is designed to be either mounted on a panel or in a standard double gang back box, be it Flush, Surface or Dry-Lining. Ideally a 47mm deep box, as this gives clear room for arranging the internals. The assembly, wherever fitted, should have a form of isolation, such as a breaker in a panel or be fed from a switched fused spur, previously installed. A single-phase feed of Live, Neutral & Earth is required.

If a wired Ethernet connection is the preferred communication method, then a standard Cat5 cable should be supplied also, to be fed into the box & snap locked into place at the open end of the Ethernet to USB adaptor.



An inadequate or incomplete install procedure may lead to the incorrect operation of the equipment and/or the incorrect information being supplied to the end user. Do not attempt to install this product if you do not have the relevant skills & experience to do so.

PROCEDURE using backbox

- Connect the Live & Neutral to the **orange lever type terminals** supplied, (Live to Brown, Neutral to Blue).
- The earth connection should be crimped and attached to the mounting plate using **1x M3x6mm screw and serrated washer**.
- The power supply can be attached to the mounting plate using **2x M3x6mm screws with serrated washers**. Depending on any physical constraints within the back box, the power supply could also be also be left loose in the backbox.
- Once wiring is complete, attach the **mounting plate** to the back box. (Note, mounting holes in opposite diagonal corners are also available for US style 4" square boxes)
- Prepare the **4 small metal tabs** by applying the **sticky pads** provided with the kit. These are required to ensure the display sits securely in the frame, allowing for any variation in the thickness of the display. **Note** only one side of the adhesive protector needs to be removed, the pads do not need to stick to the tablet display itself.



- Leave the screws slack on the metal support tabs so that they can be rotated out of the way to allow the display to be mounted.

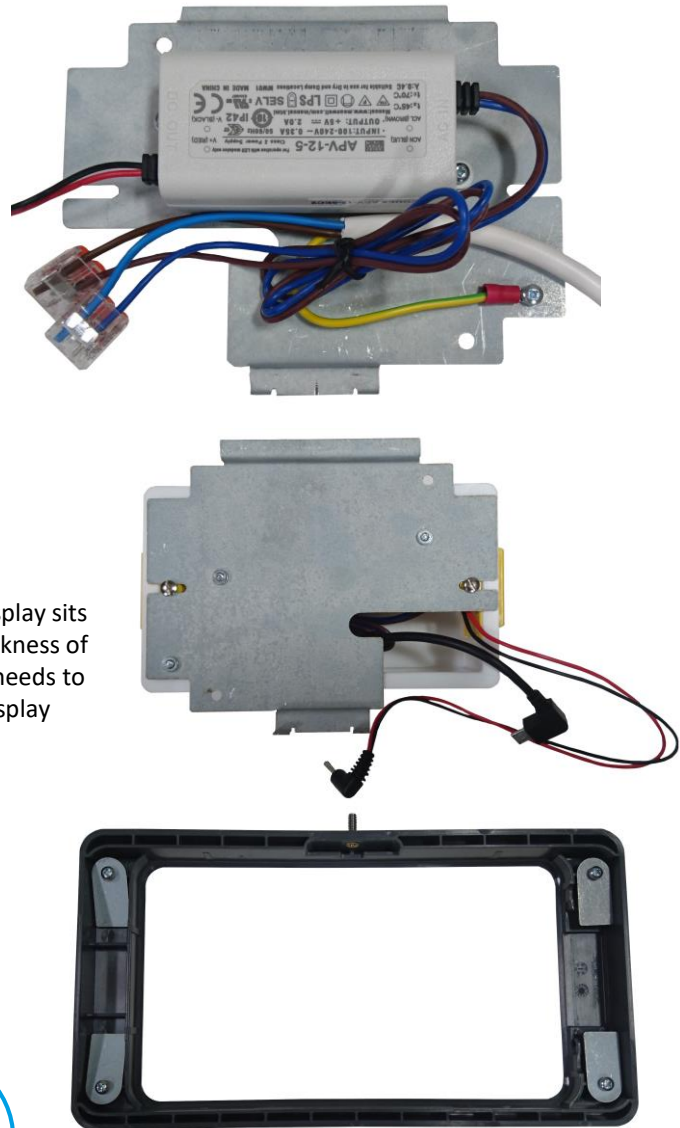

- Connect the 2.5mm barrel cable to the power socket, located on the right hand edge of the tablet, ensuring it is inserted fully home.
- Connect the USB connector (where Ethernet required), ensuring it is inserted fully home.

PROCEDURE using backbox continued

- Rotate the 4 metal support tabs and tighten the 4 screws to ensure the display is held securely.

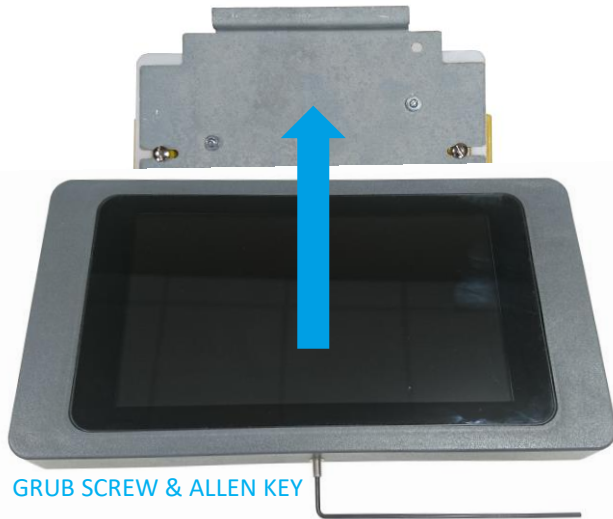

- Locate the display frame assembly over the top of the mount plate. There are grooves on the inside edge of the frame to suit. Long grooves on the top, small grooves and locking grub screw to the bottom.
- Using the Allen key supplied, and ensuring no cables have been dislodged or inadvertently crimped or squashed, tighten the grub screw to hold the frame secure. Do not over tighten the grub screw.

PROCEDURE panel mount

The panel mount procedure follows mostly the same procedure the backbox option above. Additional considerations are:

- A drill template is available to mark out the appropriate holes.
- An additional 2x M3x6mm screws with nylock nuts are provided to mount the support plate to the panel. Either the back box slots can be used or in the case of the example opposite, the mounting holes diagonally opposite in the corners. (Positions indicated by the blue arrows in the image opposite). Depending on the thickness of the panel material, longer screws may be required.
- The power supply can be mounted in the same way as described in the previous section.
- A flexible grommet strip has been provided to cover any sharp holes cut in the panel for cable access.

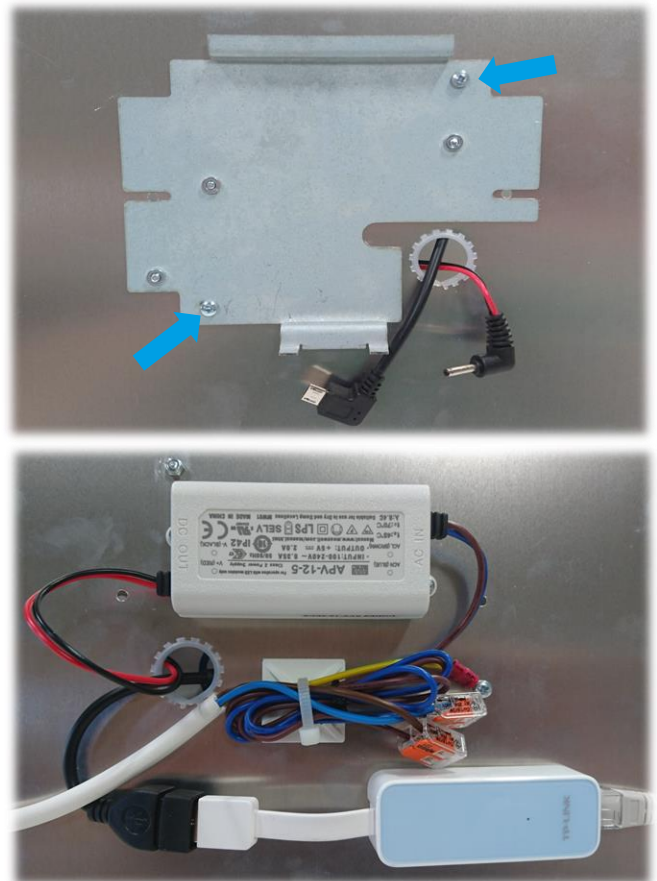

For more information or support, please contact NetThings
www.netthings.co.uk/support